

TOP OF GRID TRACK

RS.J.

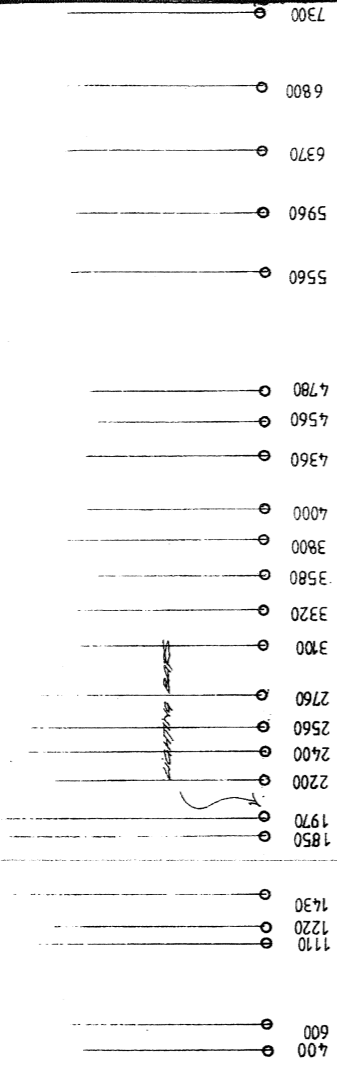

FIRE CURTAIN

Lighting bases

FLY FLOOR

LOADING DOCK

STAGE FLOOR

ORCHESTRA PIT

BASEMENT

# ATHENAEUM THEATRE

CARTER - MEROLLI ARCHITECTS P/L  
 182 Victoria Pde East Melbourne  
 Tel: 662-1870

scale: 1:25  
 june 86

AMENDED BY ALAN ROYAL & ASSOC.  
 13/1/91

Section 'A-A'

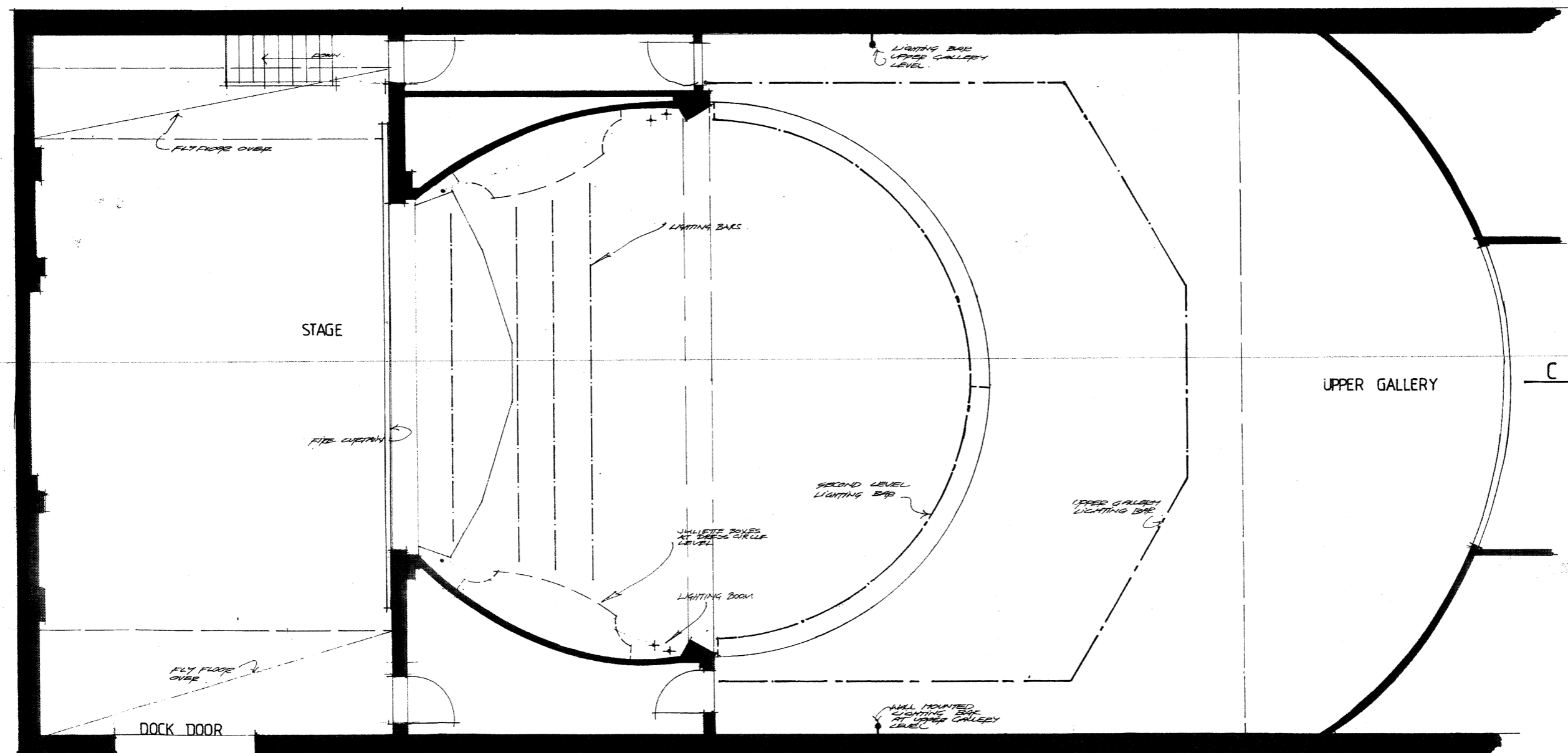

Floor Plan 1:50

ATHENAEUM THEATRE

CARTER - MEROLLI  
PTY. LTD.  
ARCHITECTS  
182 VICTORIA PDE.,  
EAST MELBOURNE 3002  
Tel. 662-1870.

FLOOR PLAN

AMENDED BY ALLAN LONELL  
& ASSOC. 13/7/89

date: JUNE 86

scale: 1:50

drawn: G.S.

checked:

job no: drawing no:

8624

TOP OF GRID

R.S.J.

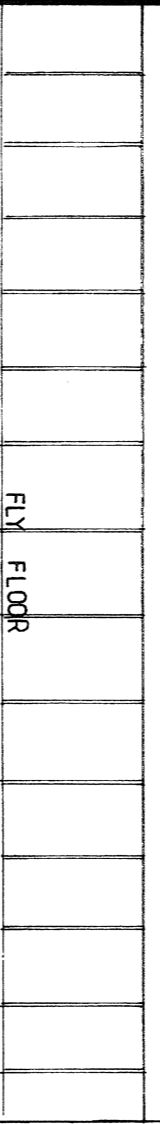

FIRE CURTAIN.

Lighting S.W.

STAGE MANAGERS PERCH

STAGE FLOOR

ORCHESTRA PIT

BASEMENT

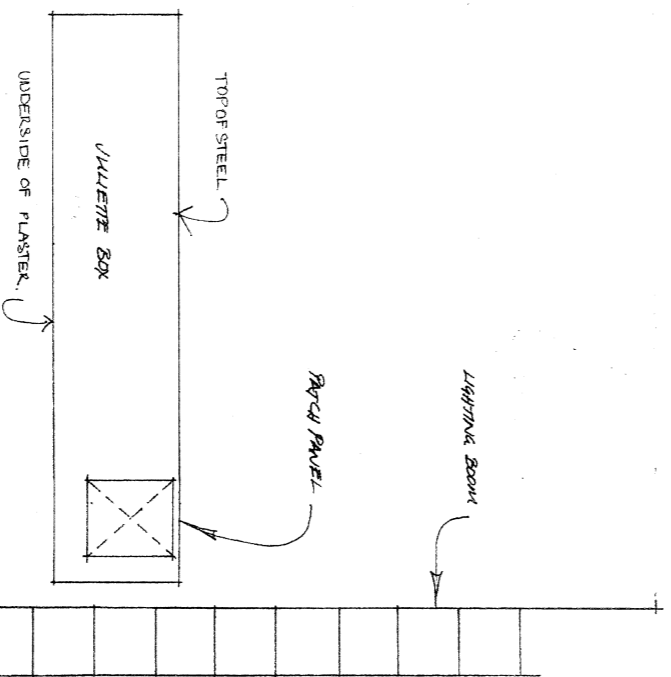

**ATHENAEUM THEATRE.**  
 CARTER - MEROLLI ARCHITECTS P/L  
 182 Victoria Pde East Melbourne.  
 TEL : 662-1870.  
 scale: 1/25  
 June 86.

AMENDED BY:  
 ALAN CORPALL & ASSOC.  
 16-9-91 & 22/11/91

Section B-B.

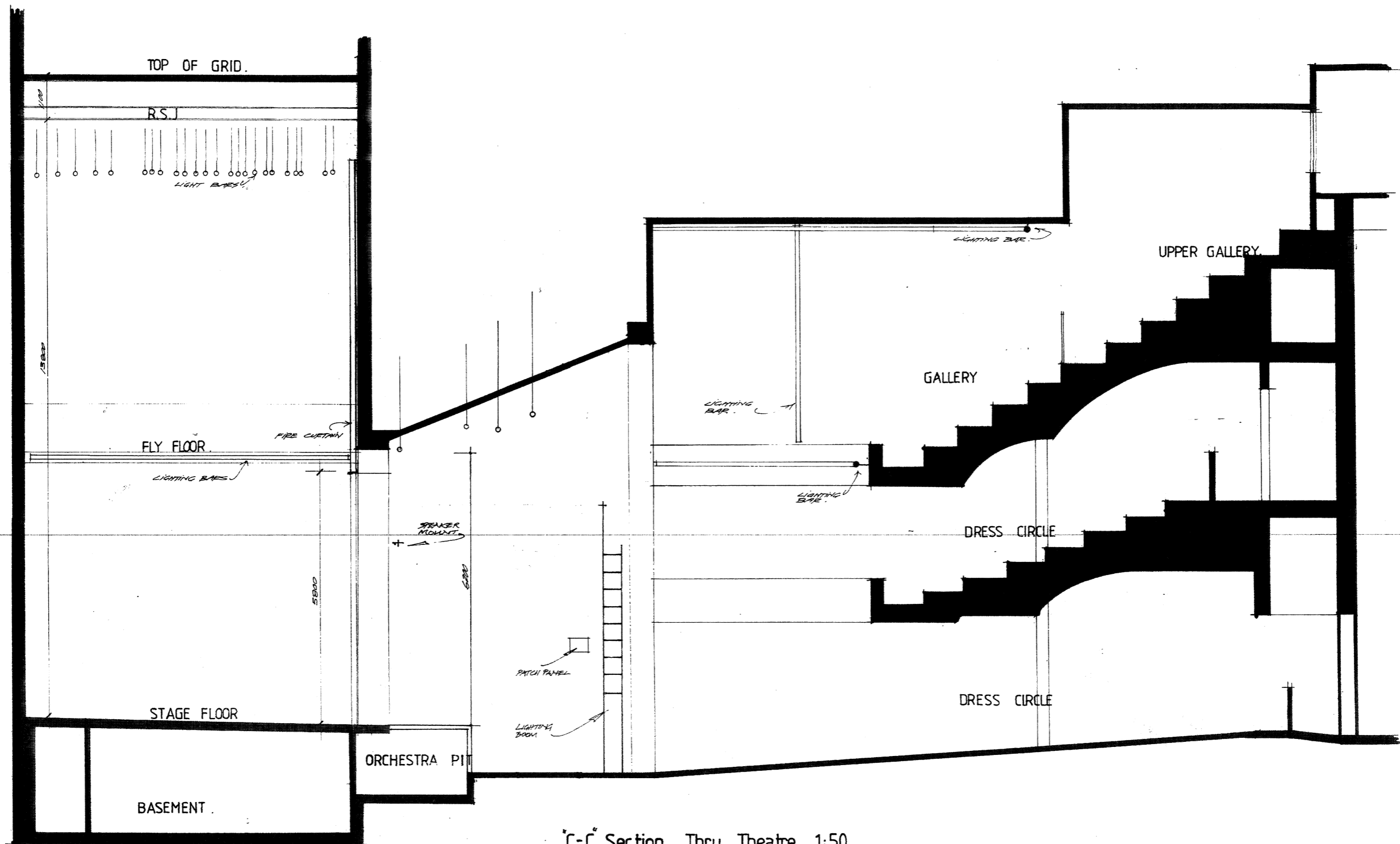

C-C Section Thru Theatre 1:50.

ATHENAEUM THEATRE

CARTER-MEROLLI  
PTY. LTD.  
ARCHITECTS  
182 VICTORIA PDE,  
EAST MELBOURNE 3001  
Tel. 662-1870.

SECTION

AMENDED BY ALCON LOVELL  
# ASSOC. 13/9/91

date: JUNE 86

scale: 1:50

drawn: G.S

checked:

job no:

drawing no:

8624

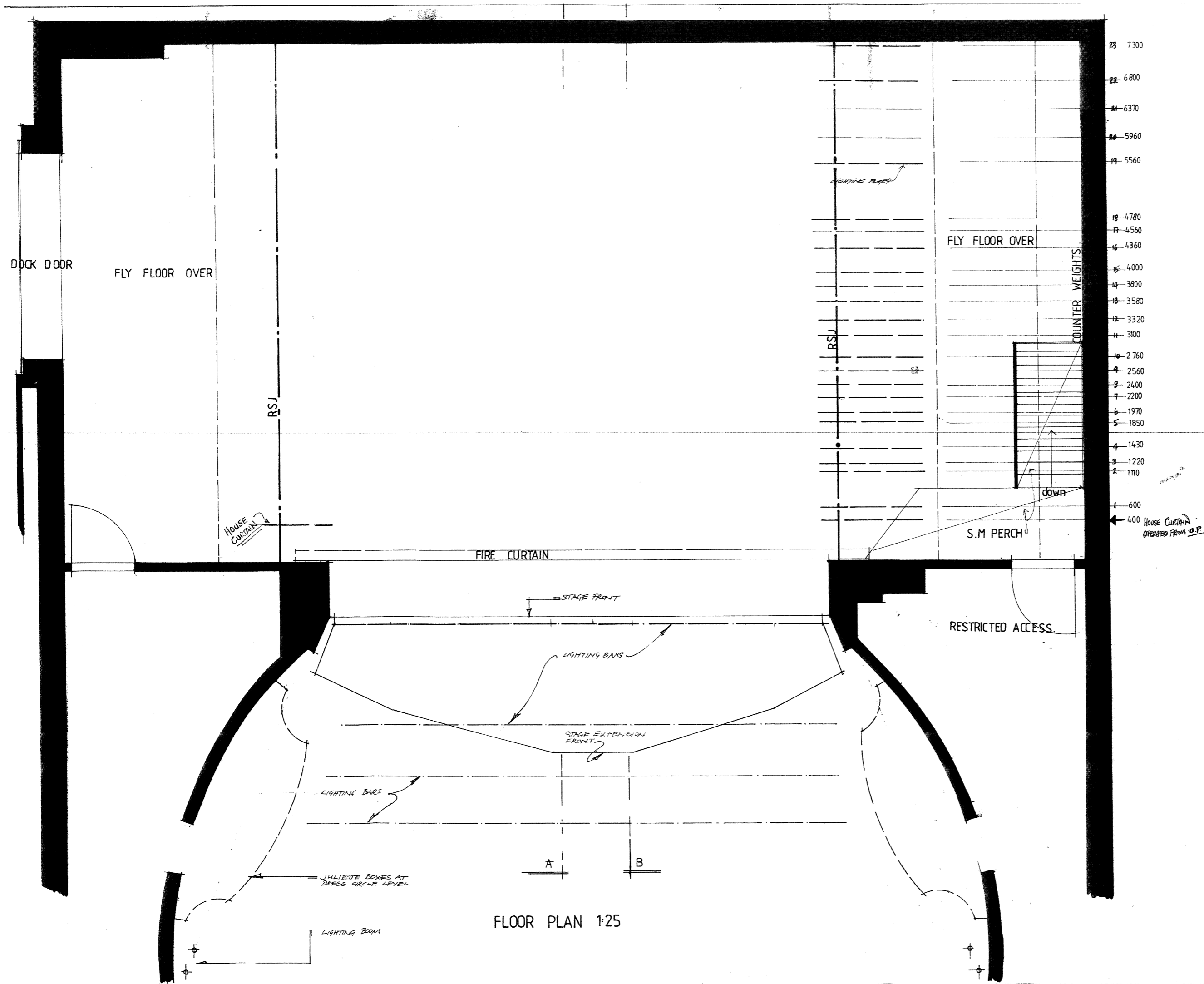

ATHENAEUM THEATRE.

CARTER-MEROLLI  
PTY. LTD.  
ARCHITECTS  
182 VICTORIA PDE,  
EAST MELBOURNE 3002.  
Tel. 662-1870

FLOOR PLAN

AMENDED BY ALAN LOVER  
& ASSOCIATES 16.7.91

date: JUNE 86

scale: 1:25

drawn: G.S.

checked:

job no:

drawing no:

8624

FLOOR PLAN 1:25